

GLADTECH Open House Sept 15 - 17, 2020



Over 20 new machines on display.

Live demonstrations.

Discuss your application on-site
with experts in their fields.

Sign up for a private consultation
with Gladwin's Press Brake
Automation Specialist.

Sept 15-17, 2020

Location

Gladwin Machinery
5170 Main Street N.E.
Minneapolis, MN 55421

Agenda/Seminars: 15th and 16th

9:00 am *Doors open*
11:00 am *Mazak*
11:30 am *Liberty Systems*
12:00 pm *Lunch both days*
1:00 pm *SafanDarley*
1:30 pm *Radan*
2:00 pm *Wila*
4:00 pm *Open House ends*

***17th by appointment only**

Come to the GLADTECH Technology Open House in Minneapolis!

Come see the world's most advanced press brake bending system in our Showroom.

Find out if Press Brake Automation fits your application.

Learn how Radan software can integrate with machines from any manufacturer.

See how compressed air laser cutting can save you thousands of dollars a month.

Details/Register here: tiny.cc/e5vjsz

*Gladwin Machinery follows the latest
COVID-19 safety guidelines.*

Registration cordially requested.

gladwinmachinery.com / 763.574.9000 (office)

GLADTECH Open House Sept 15 - 17, 2020



SafanDarley E-Brake

- Patented **All Electric** Drive System
- Consumes 70% Less Energy than Hydraulic Machines
- Fastest Cycle Time on the market
- No Set-Up Integrated Safety System
- High Accuracy +/- 0.00039"
- Low Maintenance

- 100% Electric Models from 39 to 330 Tons
 - Over 10,000 **Electric Brakes** Installed
-

Accurpress Accell-E

- Synchronized Y1/Y2 Forming Technology
- Closed Loop Hydraulic System
- Vision Touch Screen Graphical Control
- Generous Open Height/Stroke
- LazerSafe Safety System
- **Repeat Accuracy of +/- 0.0004"**
- Available 6-Axis Elite Backgauging
- WILA Precision Tooling System



GLADTECH Open House Sept 15 - 17, 2020



Wila Precision Ground Press Brake Tooling

- Reduce Tooling Set-up by 90%
 - Crowning Systems for Every Application
 - Hardened Tools Last 3-5 Times Longer
 - Sign up for the educational seminar!
-

Radan Offline Programming & Simulation for All Fabrication Equipment

- Bridges the Gap Between Design & Manufacturing
- Designed to Provide Operators with the Tools they Require to Optimize Production & Reduce Lead Times

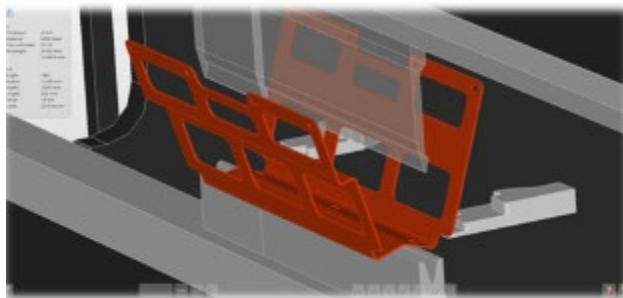
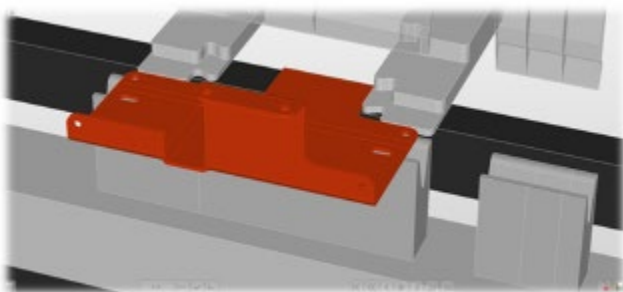
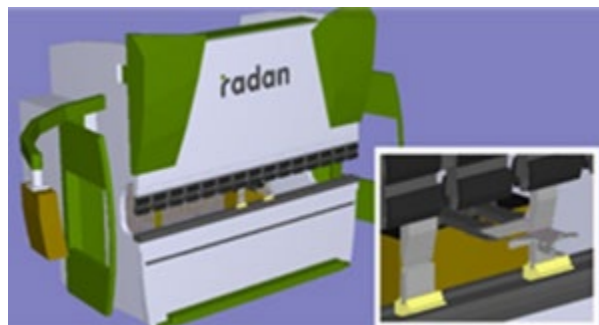

GLADTECH Open House Sept 15 - 17, 2020

Mazak 10 KW OPTIPLEX Fiber III

- **Advanced MCT 2 Cutting Head**

- ◆ Beam Diameter Control
- ◆ Autofocus Positioning
- ◆ Auto Profiler Calibration
- ◆ Auto Nozzle Changing
- ◆ Pierce Detection
- ◆ Plasma Detection
- ◆ Burn Detection
- ◆ Fine Power Ramping
- ◆ Flash Cutting



Liberty Systems High Performance Compressed Air Cutting System

- **Save up to 85% Compared to Bulk Nitrogen**
 - Reduce or Eliminate Gas Contracts
 - Exceptional Edge Quality in Aluminum
 - Average ROI of 1.5 Years
 - Packaged Plug & Play System
-





EMI Tube Processing Center

- Process standard lengths of tubing into weld-ready components quickly, easily & reliably in one continuous process.
- **Reduce labor and floor space requirements for increased profitability.**

Scotchman (demo truck)

- **U.S. made Ironworkers** from 45 to 150 Ton
- Manual to Fully-Automatic **Circular Cold Saws**



Ironworkers



Cold Saws



Norlok Clinching Machine

- Sets the standards in clinching technology.
 - **Safe. Reliable. Economical.** Pneumatically powered floor mounted and portable machines that outperform the competition.
-

GLADTECH Open House Sept 15 - 17, 2020

Marvel

- **#1 Band Saw Manufacturer**
- Horizontal & Vertical Models
- Integrated Material Handling Systems
- Manufactured in Oshkosh, WI
- Graphical Part Programming



- **Manual to Fully CNC Programmable Versions**

FlexCNC Large Bed CNC Machining Center

- Vertical Machining Center can be built to suit your needs!
- Done in one: mill, drill, tap, bevel, chamfer, helical mill, bore.



- **Easy to Program: NextGen Control and Pendulum mode.
Anyone in your shop can program the CNC!**
-

GLADTECH Open House Sept 15 - 17, 2020

Davi CNC Plate Roll / Angle Roll

- **#1 Plate Roll Manufacturer Worldwide**
 - Roll by Wire Digital Technology
 - Aided Graphical Part Programming
 - Manual to Fully Automatic Rolling
 - Automated Material Handling Systems
 - Planetary Guide Technology
-



Timesavers

- Laser Deburring
- Finishing | Straight Line Finish
- Edge Rounding
- Slag Removal
- Calibration | Precision Grinding

Flow Waterjet Cutting System

- **Waterjet reinvented – cuts virtually any material!**
- Flow performance made affordable!



Big Steel Rack

- **Increase Floor Space**
- **Improve Safety**
- Superior Organization
- Structurally Certified
- Cambered Pallet Design

GLADTECH Open House Sept 15 - 17, 2020

Emmegi Machining Center

- Phantomatic T3 Star **4-Axes** CNC Aluminum Machining Center
-

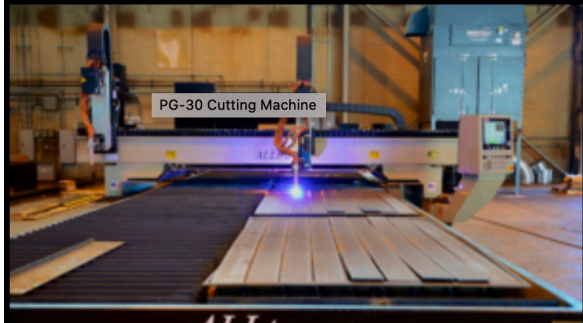

ALLtra Cutting System

- U.S. made cutting machines go beyond - incorporating **leading cutting technologies.**

Peddinghaus (booth)

- Structural steel fabricating machinery for the steel fabrication industry.
- **Latest Technology. Built to last.**
 - ◆ Drill Lines
 - ◆ Plate Processors
 - ◆ Angle lines

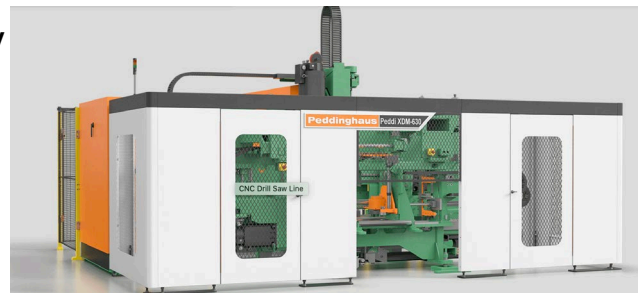

Schroder (booth)

- Learn about **Schroder's advanced bi-directional bending technology** utilizing the latest in control and drive technology!